

Description	Drawing	Contacts	Fixing thread	Ordering-No.
Male panel mount connector, fixing thread, solder		4		09 0431 81 04
		5	M12 x 0,5	09 0433 81 05
		8		09 0381 81 08



Male panel mount connector, fixing thread, solder		4	PG 9	86 4231 1002 0004
			M16 x 1,5	86 4331 1002 0004
		5	PG 9	86 4231 1002 0005
			M16 x 1,5	86 4331 1002 0005
		8	PG 9	86 4231 1002 0008
			M16 x 1,5	86 4331 1002 0008



Male panel mount connector, fixing thread, solder		4	PG 11	09 0435 87 04
		5		09 0437 87 05



Male panel mount connector, fixing thread, solder		4	PG 13,5	86 4531 1002 0004
			M20 x 1,5	86 4631 1002 0004
		5	PG 13,5	86 4531 1002 0005
			M20 x 1,5	86 4631 1002 0005



Male panel mount connector, metric fixing thread, positioning possible, solder		4	M16 x 1,5	09 0431 397 04
			M20 x 1,5	09 0439 397 04



Specifications	Panel mount connector			
Contacts	4	5	8	12
Wire gauge	max. 0,25 mm ² (max. AWG 24), single wires AWG 24 (0,25 mm ²), Power: max. 1,5 mm ² (max. AWG 16), single wires AWG 18			AWG 26 (0,14 mm ²)
Mechanical operation	> 100 Mating cycles			
Temperature range	- 40 °C / + 85 °C			
Rated voltage	250 V	60 V (125 V UL)	30 V (60 V UL)	30 V
Pollution degree	3			
Rated current (40°C)	4 A (3 A UL), Power 8 A	4 A (3 A UL), Power cont. 1-4 8 A, cont. 5 2 A	1,5 A (2 A UL)	
Contact plating	Au (Gold)			
Material of housing	PA, zinc diecasting nickel plated			

Description

Drawing

Contacts Ordering-No. ¹⁾

Male panel mount connector with single wires, AWG 24, M16 x 1,5, plastic housing

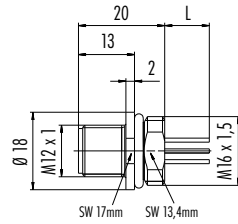

4	76 4331 0011 00004-0200
5	76 4331 0011 00005-0200
8	76 4331 0011 00008-0200
12	76 4331 0111 00012-0200

NEW

Male panel mount connector with single wires, AWG 24, M20 x 1,5, plastic housing

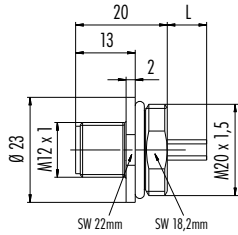

4	76 4631 0011 00004-0200
5	76 4631 0011 00005-0200
8	76 4631 0011 00008-0200
12	76 4631 0111 00012-0200

NEW

Male panel mount connector, front fastened, with single wires, AWG 24, M16 x 1,5, plastic housing

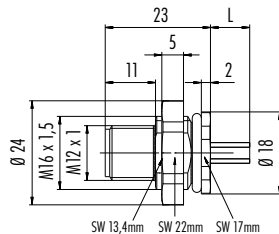

4	76 4731 3011 00004-0200
5	76 4731 3011 00005-0200
8	76 4731 3011 00008-0200
12	76 4731 3111 00012-0200

NEW

Male panel mount connector with single wires, AWG 24, metal housing

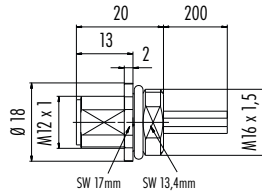

Contacts	Fixing thread	Contact insert	Ordering-No. ¹⁾		
4	M16 x 1,5 (AWG24)	black	76 0231 0011 00004-0200		
		purple	76 0231 0011 00104-0200		
		orange	76 0231 0011 00204-0200		
		yellow	76 0231 0011 00304-0200		
		green	76 0231 0011 00404-0200		
		red	76 0231 0011 00504-0200		
		blue	76 0231 0011 00604-0200		
		black	76 0231 0011 00005-0200		
		purple	76 0231 0011 00105-0200		
		orange	76 0231 0011 00205-0200		
5	M16 x 1,5 (AWG24)	yellow	76 0231 0011 00305-0200		
		green	76 0231 0011 00405-0200		
		red	76 0231 0011 00505-0200		
		blue	76 0231 0011 00605-0200		
		PG 9	76 0131 0011 00004-0200		
		PG 9 Stainless steel	76 2131 0111 00004-0200		
		PG 9 Power	09 3431 433 04		
		M16 x 1,5 Stainless steel	76 2231 0111 00004-0200		
		PG 9	76 0131 0011 00005-0200		
		PG 9 Stainless steel	76 2131 0111 00005-0200		
PG 9 Power	09 3441 433 05				
M16 x 1,5 Stainless steel	76 2231 0111 00005-0200				
8	M16 x 1,5	PG 9	76 0131 0011 00008-0200		
		PG 9 Stainless steel	76 2131 0111 00008-0200		
		M16 x 1,5 Stainless steel	76 2231 0111 00008-0200		
		PG 9	76 0131 0111 00012-0200		
		M16 x 1,5	76 0231 0111 00012-0200		
		12	M16 x 1,5	PG 9	76 0131 0111 00012-0200
				M16 x 1,5	76 0231 0111 00012-0200

Male panel mount connector with single wires/Power with single wires, metal housing

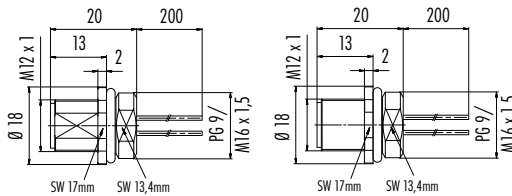

4	M16 x 1,5	PG 9	76 0131 0011 00004-0200		
		PG 9 Stainless steel	76 2131 0111 00004-0200		
		PG 9 Power	09 3431 433 04		
		M16 x 1,5 Stainless steel	76 2231 0111 00004-0200		
		PG 9	76 0131 0011 00005-0200		
		PG 9 Stainless steel	76 2131 0111 00005-0200		
		PG 9 Power	09 3441 433 05		
		M16 x 1,5 Stainless steel	76 2231 0111 00005-0200		
		PG 9	76 0131 0011 00008-0200		
		PG 9 Stainless steel	76 2131 0111 00008-0200		
5	M16 x 1,5	PG 9	76 0131 0011 00008-0200		
		PG 9 Stainless steel	76 2131 0111 00008-0200		
		M16 x 1,5 Stainless steel	76 2231 0111 00008-0200		
		PG 9	76 0131 0111 00012-0200		
		M16 x 1,5	76 0231 0111 00012-0200		
		8	M16 x 1,5	PG 9	76 0131 0111 00012-0200
				PG 9 Stainless steel	76 2131 0111 00012-0200
				M16 x 1,5 Stainless steel	76 2231 0111 00012-0200
				PG 9	76 0131 0111 00012-0200
				M16 x 1,5	76 0231 0111 00012-0200
12	M16 x 1,5			PG 9	76 0131 0111 00012-0200
				M16 x 1,5	76 0231 0111 00012-0200

Stainless steel version

Male panel mount connector with single wires, AWG 24, metal housing

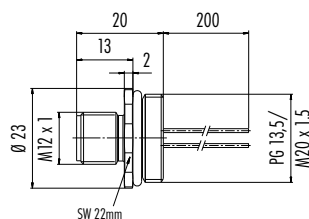

4	PG 13,5	76 0331 0111 00004-0200
	M20 x 1,5	76 0431 0111 00004-0200
5	PG 13,5	76 0331 0111 00005-0200
	M20 x 1,5	76 0431 0111 00005-0200
8	PG 13,5	76 0331 0111 00008-0200
	M20 x 1,5	76 0431 0111 00008-0200
12	PG 13,5	76 0331 0111 00012-0200
	M20 x 1,5	76 0431 0111 00012-0200

Description

Male panel mount connector, solder, metal housing

Drawing

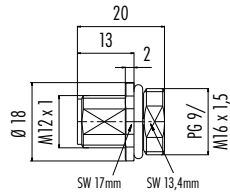

Contacts

Fixing thread

Ordering-No.

4	PG 9	86 0131 0002 00004
	M16 x 1,5	86 0231 0002 00004
5	PG 9	86 0131 0002 00005
	M16 x 1,5	86 0231 0002 00005
8	PG 9	86 0131 0002 00008
	M16 x 1,5	86 0231 0002 00008

Male panel mount connector with single wires, Outdoor, IP68, IP69

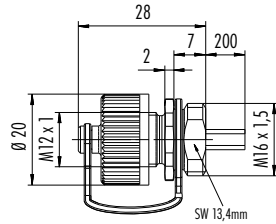

NEW

4	M16 x 1,5	09 3431 284 04
---	-----------	----------------

Male panel mount connector, screw clamp termination/POWER screw clamp termination

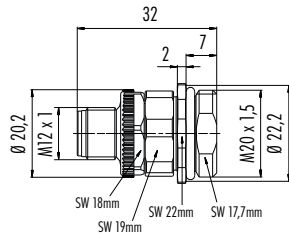

4 Power		99 0431 500 04
5 Power	M20 x 1,5	99 0433 500 05
8		86 0431 0003 00008

Male panel mount connector, positioning possible, with single wires, metal housing

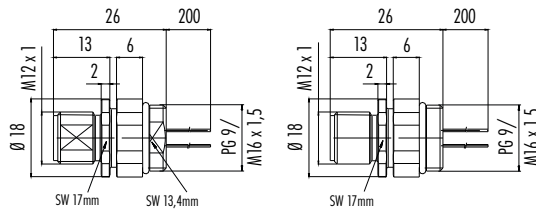

Stainless steel version



4	PG 9	76 0731 0011 00004-0200
	M16 x 1,5	76 0831 0011 00004-0200
	PG 9 Stainless steel	76 2731 0111 00004-0200
	M16 x 1,5 Stainless steel	76 2831 0111 00004-0200
5	PG 9	76 0731 0011 00005-0200
	M16 x 1,5	76 0831 0011 00005-0200
	PG 9 Stainless steel	76 2731 0111 00005-0200
	M16 x 1,5 Stainless steel	76 2831 0111 00005-0200
8	PG 9	76 0731 0011 00008-0200
	M16 x 1,5	76 0831 0011 00008-0200
	PG 9 Stainless steel	76 2731 0111 00008-0200
	M16 x 1,5 Stainless steel	76 2831 0111 00008-0200
12	PG 9	76 0731 0111 00012-0200
	M16 x 1,5	76 0831 0111 00012-0200
4	PG 9	76 0531 1011 00004-0200
	M16 x 1,5 (AWG 24)	76 0631 1011 00004-0200
5	PG 9	76 0531 1011 00005-0200
	M16 x 1,5 (AWG 24)	76 0631 1011 00005-0200
8	PG 9 Stainless steel	76 2531 1111 00005-0200
	PG 9	76 0531 1011 00008-0200
12	M16 x 1,5 (AWG 24)	76 0631 1011 00008-0200
	PG 9 Stainless steel	76 2531 1111 00008-0200
4	PG 9	76 0531 1111 00012-0200
	M16 x 1,5 (AWG 24)	76 0631 1111 00012-0200

Male panel mount connector, front fastened, with single wires, metal housing

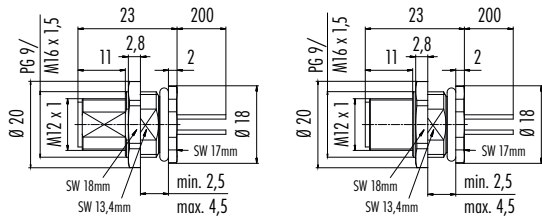

Stainless steel version



4	PG 9	76 0531 1011 00004-0200
	M16 x 1,5 (AWG 24)	76 0631 1011 00004-0200
5	PG 9	76 0531 1011 00005-0200
	M16 x 1,5 (AWG 24)	76 0631 1011 00005-0200
8	PG 9 Stainless steel	76 2531 1111 00005-0200
	PG 9	76 0531 1011 00008-0200
12	M16 x 1,5 (AWG 24)	76 0631 1011 00008-0200
	PG 9 Stainless steel	76 2531 1111 00008-0200

Male panel mount connector, rectangular flange, with single wires, metal housing

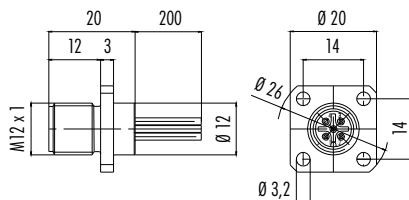

4	-	76 0931 0111 00004-0200
5	-	76 0931 0111 00005-0200
8	-	76 0931 0111 00008-0200
12	-	76 0931 0111 00012-0200

¹⁾ Standard wire length is 200 mm for 76-order-numbers. Other length on request.

Description	Drawing	Contacts	Fixing thread	Ordering-No.
Male panel mount connector, front fastened, solder, unmounted, metal housing		4	PG 9	86 0531 1002 00004
			M16 x 1,5	86 0631 1002 00004
		5	PG 9	86 0531 1002 00005
			M16 x 1,5	86 0631 1002 00005
		8	PG 9	86 0531 1002 00008
			M16 x 1,5	86 0631 1002 00008



Male panel mount connector, dip-solder, metal housing		4	PG 9	86 0131 0000 00004
			M16 x 1,5	86 0231 0000 00004
		5	PG 9	86 0131 0000 00005
			M16 x 1,5	86 0231 0000 00005
		8	PG 9	86 0131 0000 00008
			M16 x 1,5	86 0231 0000 00008
		12	PG 9	86 0131 0100 00012
			M16 x 1,5	86 0231 0100 00012



Male panel mount connector, front fastened, dip-solder, metal housing		4	PG 9	86 0531 1000 00004
			M16 x 1,5	86 0631 1000 00004
		5	PG 9	86 0531 1000 00005
			M16 x 1,5	86 0631 1000 00005
		8	PG 9	86 0531 1000 00008
			M16 x 1,5	86 0631 1000 00008
		12	PG 9	86 0531 1100 00012
			M16 x 1,5	86 0631 1100 00012

Stainless steel version



Male panel mount connector, front fastened, dip-solder, with shielding sheet		4		86 0531 1120 00004
		5	PG 9	86 0531 1120 00005
		8		86 0531 1120 00008
		12		86 0531 1120 00012

PCB thickness: 1,6 mm

Male angled panel mount connector, front fastened, dip-solder, with shielding sheet		4		86 0531 1121 00004
		5	PG 9	86 0531 1121 00005

PCB thickness: 1,6 mm

Male panel mount connector, front fastened, dip-solder, metal housing		4		86 1031 1100 00004
		5	M12 x 1	86 1031 1100 00005
		8		86 1031 1100 00008
		12		86 1031 1100 00012



Description

Male receptacle for PCB assembly

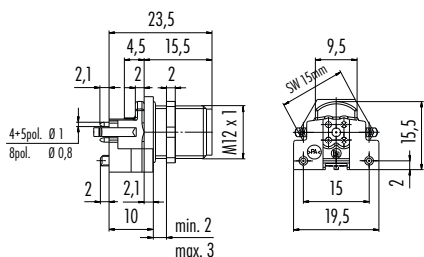

PCB thickness: 1,6 mm

View of mating side



Contacts Ordering-No.

4	99 3431 200 04	
	99 3431 458 04	with shielding sheet
5	99 3441 200 05	
	99 3441 458 05	with shielding sheet
8	99 3481 200 08	
	99 3481 458 08	with shielding sheet

Male angled receptacle, for PCB assembly

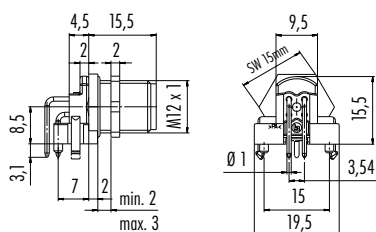

PCB thickness: 1,6 mm

View of mating side



4	99 3431 202 04	
	99 3431 601 04	with shielding sheet
5	99 3441 202 05	
	99 3441 601 05	with shielding sheet
8	99 3481 202 08	
	99 3481 601 08	with shielding sheet

Male receptacle, SMT, with housing, not shieldable/shieldable

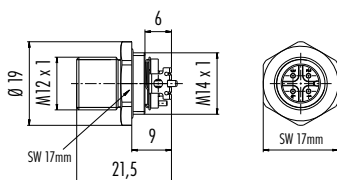

Contacts	Mounting height	not shieldable	shieldable
4		99 3431 351 04	99 3431 401 04
5	9 mm	99 3441 351 05	99 3441 401 05
8		99 3481 351 08	99 3481 401 08

NEW

Male receptacle, SMT, not shieldable/shieldable

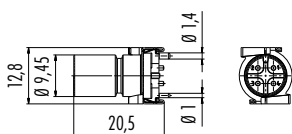

4		09 0431 600 04	09 0431 601 04
5	-	09 0433 600 05	09 0433 601 05
8		09 0381 600 08	09 0381 601 08

NEW

Male panel mount connector M16, with shielded PUR-cable

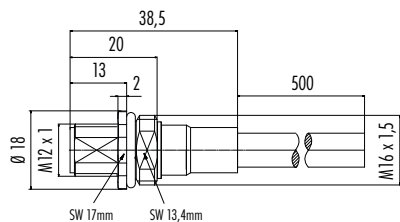

Contacts	Cable length, PUR	Fixing thread	Ordering-No.
5			70 3441 785 05
8	0,5 m	M16 x 1,5	70 3481 785 08

Male panel mount connector PG 9, front fastened, with shielded PUR-cable

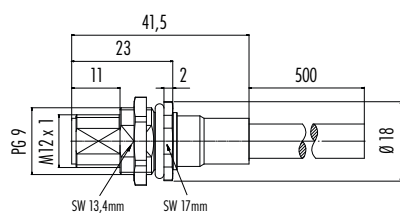

Hexagonal nut enclosed loose

5	0,5 m	PG 9	70 3441 287 05
8			70 3481 287 08

Description

Female panel mount connector, solder, plastic housing



Drawing

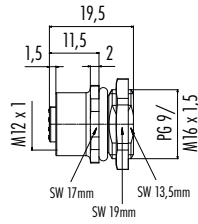

Hexagonal nut enclosed loose



Contacts

Fixing thread

Ordering-No.

4	PG 9	86 4232 1002 00004
	M16 x 1,5	86 4332 1002 00004
5	PG 9	86 4232 1002 00005
	M16 x 1,5	86 4332 1002 00005
8	PG 9	86 4232 1002 00008
	M16 x 1,5	86 4332 1002 00008

Female panel mount connector, front fastened, solder, plastic housing

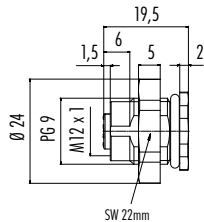

Hexagonal nut enclosed loose

4	PG 9	86 4832 3002 00004
5		86 4832 3002 00005
8		86 4832 3002 00008

Female panel mount connector, front fastened, dip-solder, plastic housing

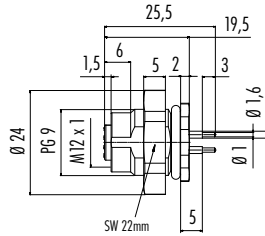

Hexagonal nut enclosed loose

4	PG 9	86 4832 3000 00004
5		86 4832 3000 00005
8		86 4832 3000 00008

Female panel mount connector with single wires, AWG 24, M16 x 1,5, plastic housing

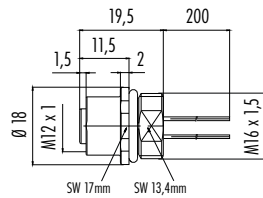

Contacts **Ordering-No. ¹⁾**

4	76 4332 0011 00004-0200
5	76 4332 0011 00005-0200
8	76 4332 0011 00008-0200
12	76 4332 0111 00012-0200

NEW

Female panel mount connector, front fastened, with single wires, AWG 24, PG 9, plastic housing

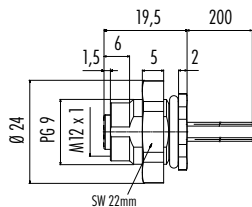

4	76 4832 3011 00004-0200
5	76 4832 3011 00005-0200
8	76 4832 3011 00008-0200
12	76 4832 3111 00012-0200

NEW

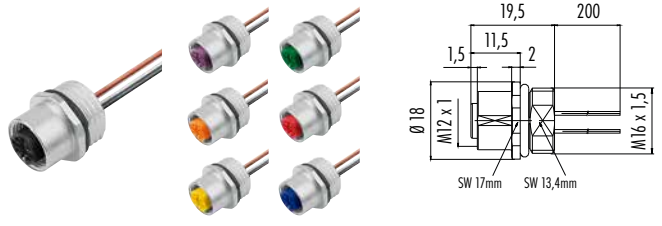
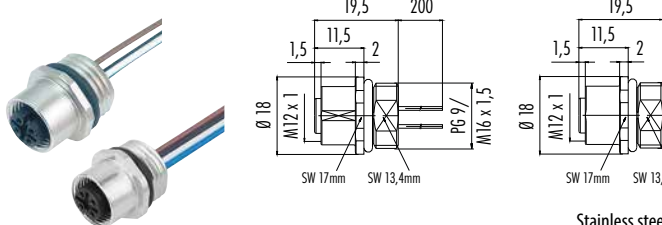
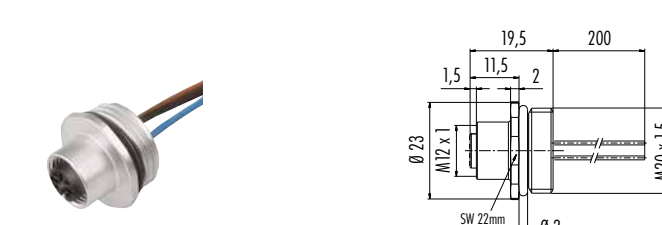
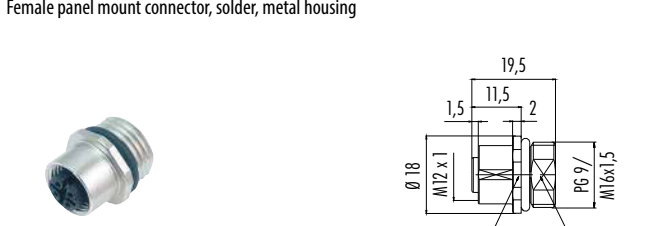
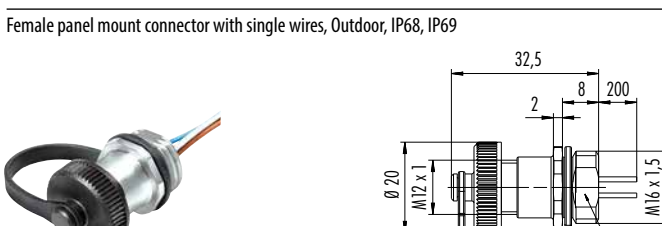
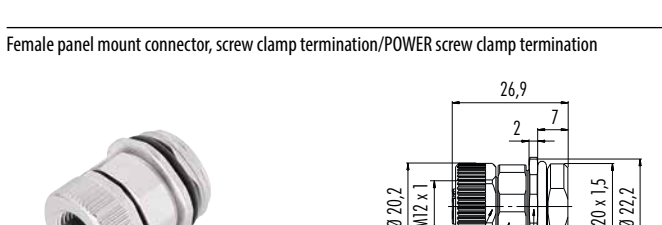
Description	Drawing	Contacts	Fixing thread	Contact insert	Ordering-No. ¹⁾
Female panel mount connector with single wires, AWG 24, metal housing		4	M16 x 1,5 (AWG24)	black purple orange yellow green red blue	76 0232 0011 00004-0200 76 0232 0011 00104-0200 76 0232 0011 00204-0200 76 0232 0011 00304-0200 76 0232 0011 00404-0200 76 0232 0011 00504-0200 76 0232 0011 00604-0200
Female panel mount connector with single wires/Power with single wires, metal housing		4 5 8 12	PG 9 PG 9 Stainless steel PG 9 Power M16 x 1,5 Stainless steel	black	76 0132 0011 00004-0200 76 2132 0111 00004-0200 09 3432 433 04 76 2232 0111 00004-0200 76 0132 0011 00005-0200 76 2132 0111 00005-0200 09 3442 433 05 76 2232 0111 00005-0200 76 0132 0011 00008-0200 76 2232 0111 00008-0200 76 0132 0011 00012-0200 76 2232 0111 00012-0200
Female panel mount connector with single wires, AWG 24, metal housing		4 5 8 12	M20 x 1,5	black	76 0432 0111 00004-0200 76 0432 0111 00005-0200 76 0432 0111 00008-0200 76 0432 0111 00012-0200
Female panel mount connector, solder, metal housing		4 5 8	PG 9 M16 x 1,5		86 0132 0002 00004 86 0232 0002 00004 86 0132 0002 00005 86 0232 0002 00005 86 0132 0002 00008 86 0232 0002 00008
Female panel mount connector with single wires, Outdoor, IP68, IP69		4	M16 x 1,5		09 3432 284 04
Female panel mount connector, screw clamp termination/POWER screw clamp termination		4 Power 5 Power 8	M20 x 1,5		99 0432 500 04 99 0434 500 05 86 0432 0003 00008

¹⁾ Standard wire length is 200 mm for 76-order-numbers. Other length on request.

Description

Drawing

Female panel mount connector, positioning possible, with single wires, metal housing

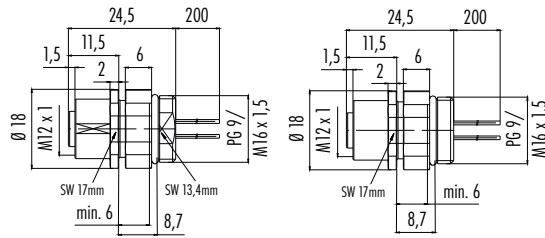

Stainless steel version

Contacts

Fixing thread

Ordering-No. ¹⁾

4	PG 9	76 0732 0011 00004-0200
	M16 x 1,5	76 0832 0011 00004-0200
	PG 9	76 2732 0111 00004-0200
	M16 x 1,5	76 2832 0111 00004-0200
5	PG 9	76 0732 0011 00005-0200
	M16 x 1,5	76 0832 0011 00005-0200
	PG 9	76 2732 0111 00005-0200
	M16 x 1,5	76 2832 0111 00005-0200
8	PG 9	76 0732 0011 00008-0200
	M16 x 1,5	76 0832 0111 00008-0200
	PG 9	76 2732 0111 00008-0200
	M16 x 1,5	76 2832 0111 00008-0200
12	PG 9	76 0732 0111 00012-0200
	M16 x 1,5	76 0832 0111 00012-0200

Female panel mount connector, front fastened, with single wires, metal housing

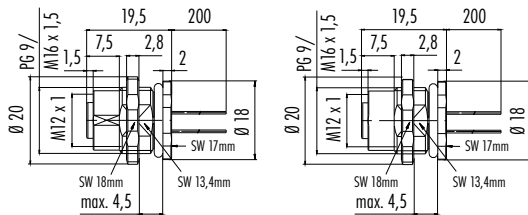

Stainless steel version

4	M16 x 1,5	76 0632 1011 00004-0200
	PG 9	76 2532 1111 00004-0200
	PG 9	76 0532 1011 00005-0200
	M16 x 1,5	76 0632 1011 00005-0200
5	PG 9	76 2532 1111 00005-0200
	PG 9	76 0532 1011 00008-0200
8	M16 x 1,5	76 0632 1011 00008-0200
	PG 9	76 2532 1111 00008-0200
12	PG 9	76 0532 1111 00012-0200
	M16 x 1,5	76 0632 1111 00012-0200

Female panel mount connector, rectangular flange, with single wires, metal housing

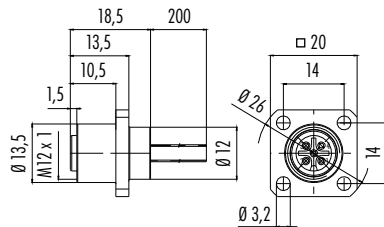

4	-	76 0932 0111 00004-0200
5	-	76 0932 0111 00005-0200
8	-	76 0932 0111 00008-0200
12	-	76 0932 0111 00012-0200

Female panel mount connector, front fastened, solder, unmounted, metal housing

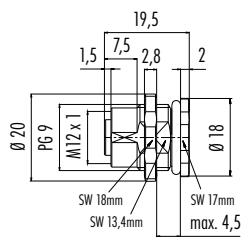

4	PG 9	86 0532 1002 00004
	M16 x 1,5	86 0632 1002 00004
5	PG 9	86 0532 1002 00005
	M16 x 1,5	86 0632 1002 00005
8	PG 9	86 0532 1002 00008
	M16 x 1,5	86 0632 1002 00008

Female panel mount connector, dip-solder, metal housing

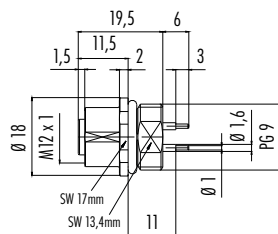

4	PG 9	86 0132 0000 00004
	M16 x 1,5	86 0232 0000 00004
5	PG 9	86 0132 0000 00005
	M16 x 1,5	86 0232 0000 00005
8	PG 9	86 0132 0000 00008
	M16 x 1,5	86 0232 0000 00008
12	PG 9	86 0132 0100 00012
	M16 x 1,5	86 0232 0100 00012

Description

Drawing

Contacts

Fixing thread

Ordering-No.

Female panel mount connector, front fastened, dip-solder, 6 mm contact length

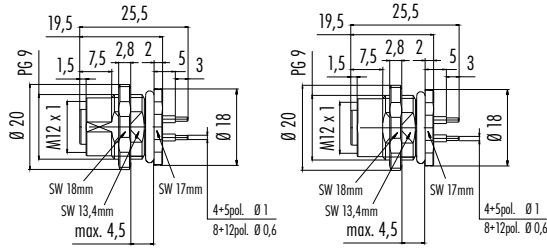

Stainless steel version



4	PG 9	86 0532 1000 0004
	M16 x 1,5	86 0632 1000 0004
5	PG 9	86 0532 1000 0005
	M16 x 1,5	86 0632 1000 0005
8	PG 9	86 2532 1100 0005
	Stainless steel	86 0532 1000 0008
8	M16 x 1,5	86 0632 1000 0008
	PG 9	86 2532 1100 0008
12	PG 9	86 0532 1100 0012
	M16 x 1,5	86 0632 1100 0012

Female panel mount connector, front fastened, dip-solder, 12 mm contact length

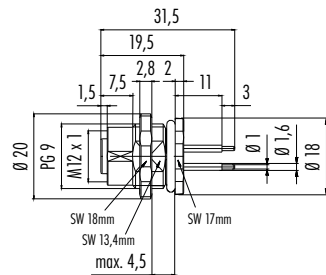

4	PG 9	09 3432 92 04
5	PG 9	09 3442 92 05

Female panel mount connector, front fastened, dip-solder, with shielding sheet

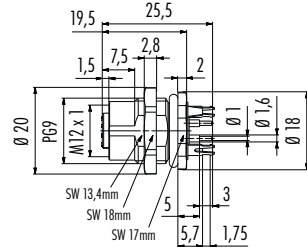

PCB thickness: 1,6 mm

4		86 0532 1120 0004
5	PG 9	86 0532 1120 0005
8		86 0532 1120 0008
12		86 0532 1120 0012

Female panel mount connector gewinkelt, front fastened, dip-solder, with shielding sheet

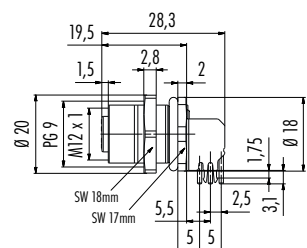

PCB thickness: 1,6 mm

4	PG 9	86 0532 1121 0004
5	PG 9	86 0532 1121 0005

Male receptacle for PCB assembly

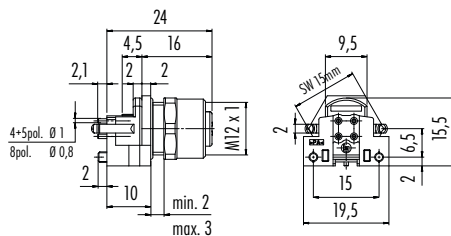

PCB thickness: 1,6 mm

View of mating side



Contacts	Ordering-No.
4	99 3432 200 04
4	99 3432 458 04 with shielding sheet
5	99 3442 200 05
5	99 3442 458 05 with shielding sheet
8	99 3482 200 08
8	99 3482 458 08 with shielding sheet

Male angled receptacle, for PCB assembly

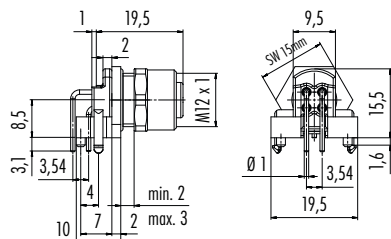

PCB thickness: 1,6 mm

View of mating side



4	99 3432 202 04
4	99 3432 601 04 with shielding sheet
5	99 3442 202 05
5	99 3442 601 05 with shielding sheet
8	99 3482 202 08
8	99 3482 601 08 with shielding sheet

Description

Drawing

Contacts **Mounting height** **not shieldable** **shieldable**

Female panel mount connector, SMT, with housing, not shieldable/shieldable

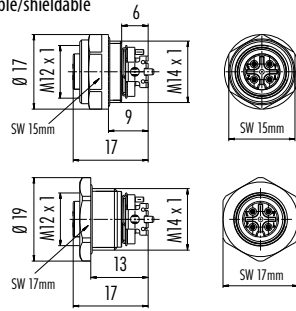

Mounting height 9 mm

Mounting height 13 mm

NEW

Contacts	Mounting height	not shieldable	shieldable
4	9 mm	99 3432 351 04	99 3432 401 04
	13 mm	99 3432 352 04	99 3432 402 04
5	9 mm	99 3442 351 05	99 3442 401 05
	13 mm	99 3442 352 05	99 3442 402 05
8	9 mm	99 3482 351 08	99 3482 401 08
	13 mm	99 3482 352 08	99 3482 402 08

Female panel mount connector, SMT, not shieldable/shieldable

4		09 0432 600 04	09 0432 601 04
5	-	09 0434 600 05	09 0434 601 05
8		09 0484 600 08	09 0484 601 08

NEW

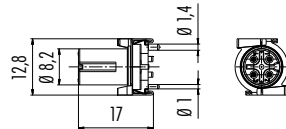

Female panel mount connector M16, with shielded PUR-cable

Contacts	Cable length, PUR	Fixing thread	Ordering-No.
5	0,5 m	M16 x 1,5	70 3442 785 05
8			70 3482 785 08

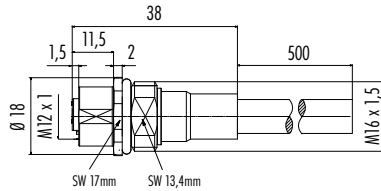

Female panel mount connector PG 9, front fastened, with shielded PUR-cable

5	0,5 m	PG 9	70 3442 287 05
8			70 3482 287 08

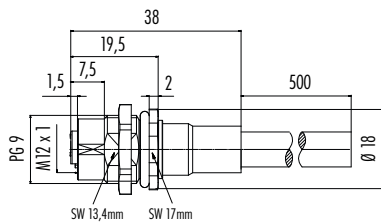

Hexagonal nut enclosed loose

Panel cut out

Panel mount connector

With flats as anti-rotation device

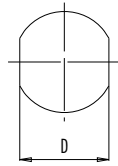

With bore hole

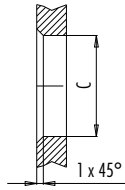

With thread to screw in

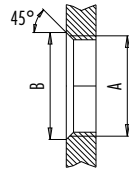

	A	B	C	D
PG 9	PG 9	16,2	15,3	13,5
PG 13,5	PG 13,5	21,5	20,5	—
M16x1,5	M16x1,5	17,0	16,1	13,5
M20x1,5	M20x1,5	21,0	20,1	—

Tightening moment
 Metal housing 6,25 Nm
 Plastic housing 3,75 Nm

alternativ

Panel mount connector, front fastened

With flats as anti-rotation device

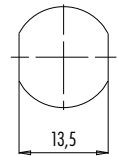

With bore hole

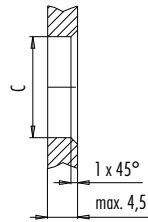

	C
PG 9	15,3
M16x1,5	16,1

Tightening moment
 Metal housing 6,25 Nm
 Plastic housing 3,75 Nm

Panel mount connector, positioning possible



Tightening moment
 Metal housing 6,25 Nm
 Plastic housing 3,75 Nm

Panel mount connector, screw clamp termination

With bore hole

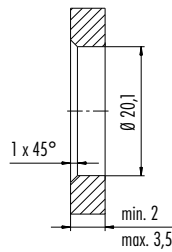

With thread to screw in

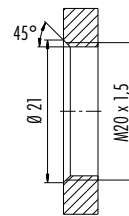

Tightening moment
 M20 x 1,5 2 Nm

Panel mount connector, with thread M12

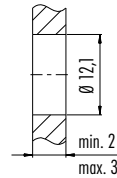

Tightening moment
 M12 x 1,5 6,25 Nm

Panel mount connector, square flange

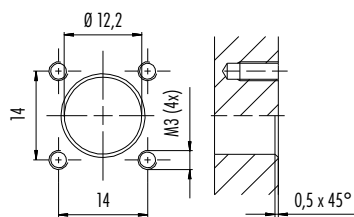

Description	Drawing	Ordering-No.
-------------	---------	--------------

Protection cap for male cable connector, IP67

08 2424 010 000



Protection cap for female cable connector, IP67

08 2425 010 000



Protection cap for male panel mount connector, IP67

Hole-Ø D	Ordering-No.
3 mm	08 2615 000 000
12,5 mm	08 2676 000 000

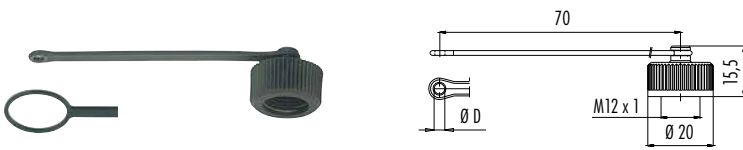

Protection cap for female panel mount connector, IP67

3 mm	08 2616 000 000
12,5 mm	08 2677 000 000

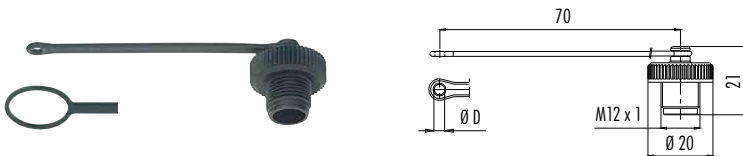

Protection cap for male panel mount connector, IP67, for front mounting

11 mm	08 2989 000 000
14,5 mm	08 2990 000 000

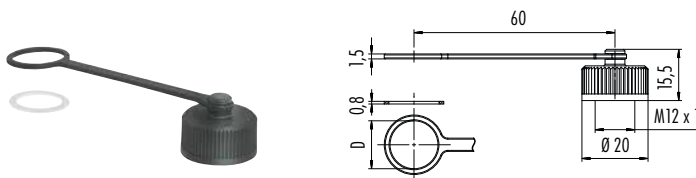

Protection cap for female panel mount connector, IP67, for front mounting

14,5 mm 08 2991 000 000

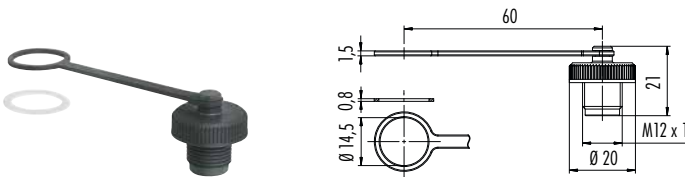

Protection cap for female connector, IP67

Ordering-No.
08 2769 000 000



Dummy plug PG 9/M16 x1,5

Thread	Ordering-No.
PG 9	08 3128 000 000
M16 x 1,5	08 3129 000 000

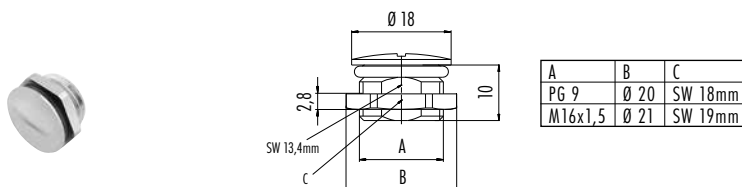

Description

Drawing

Thread B Wrench size A Ordering-No.

Hexagonal nut for fixing thread

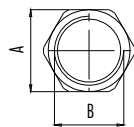

Gewinde B Thread B	Schlüsselweite A Wrench size A
PG 9	SW18 mm
PG 11	SW21 mm
PG 13,5	SW23 mm
M16 x 1,5	SW19 mm
M20 x 1,5	SW24 mm

PG 9	SW 18 mm	16 0402 001
PG 11	SW 21 mm	16 0403 001
PG 13,5	SW 23 mm	16 0401 001
M16 x 1,5	SW 19 mm	16 0916 001
M20 x 1,5	SW 24 mm	16 0917 001

Ring nut for fixing thread

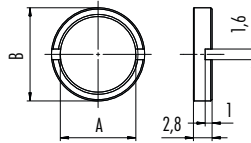

Thread A Diameter B Ordering-No.

PG 9	18 mm	01 5322 001
M12 x 1	14 mm	01 5325 001
M16 x 1,5	18 mm	01 5244 001

Mounting spanner for ring nut

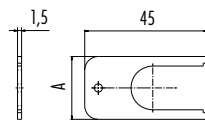

Gewinde/thread	A
PG 9/M16x1,5	23
M12x1	19

Thread Measure A Ordering-No.

PG 9/M16 x 1,5	23 mm	07 0084 000
M12 x 1	19 mm	07 0083 000

Shielding sheet for panel mount connector, fastened from back side

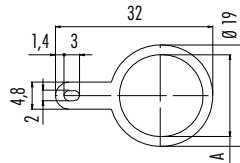

Thread Measure A Ordering-No.

PG 9	15,3 mm	04 0734 124
M16 x 1,5	16,1 mm	04 0735 124

Flat seal for fixing thread PG 9/M16 x 1,5

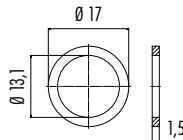

Ordering-No.

16 1125 071

Sleeve against inadvertent unmating under load

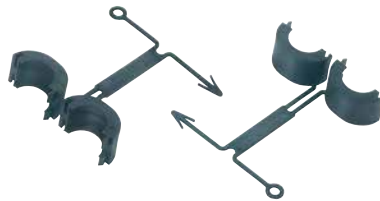

16 0977 000

Seal for plastic rectangular flange connector

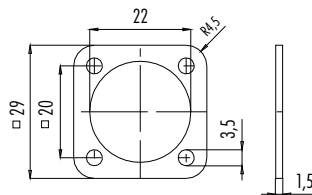

16 8091 000

Seal for metal rectangular flange connector

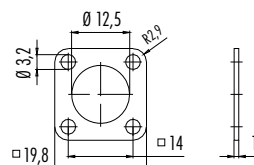

16 0959 000

Description	Drawing	Ordering-No.
-------------	---------	--------------

Screwing for tube

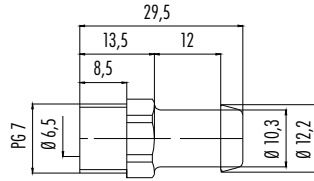

02 0273 000

PCB with one LED green/yellow, for mounting in cable connectors, screw termination

08 0462 000 000

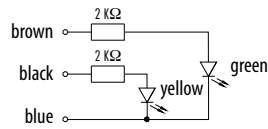
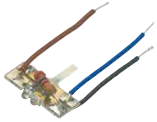

Hexagon torque spanner SW 13 mm, 0,6 Nm

07 0086 000

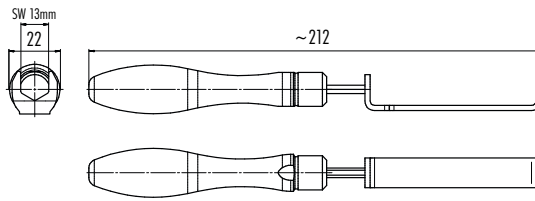

Hexagon torque spanner SW 18 mm, 0,6 Nm

07 0079 000

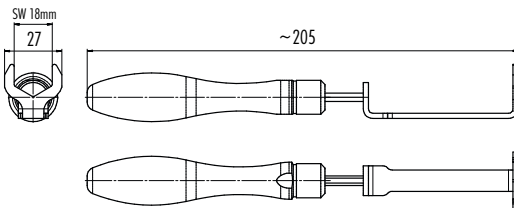

Mounting tool for M12 locking ring

07 0078 000



Male contact, PU = 100 pieces

Wire gauge	AWG	Pieces	Ordering-No.
0,14 – 0,34 mm ²	26–22	100	61 1224 146
0,34 – 0,5 mm ²	22–20	100	61 1154 146
0,75 – 1,0 mm ²	18–16	100	61 1225 146
1,0 – 1,5 mm ²	16	100	61 1226 146

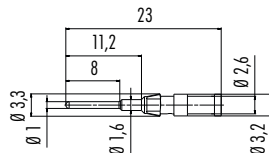

NEW

Female contact, PU = 100 pieces

0,14 – 0,34 mm ²	26–22	100	61 1227 146
0,34 – 0,5 mm ²	22–20	100	61 1155 146
0,75 – 1,0 mm ²	18–16	100	61 1228 146
1,0 – 1,5 mm ²	16	100	61 1229 146

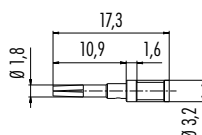

NEW

Description**Drawing****Ordering-No.**

Crimping tool for turned crimp contacts

66 0003 001



Extraction tool for turned crimp contacts

66 0004 001

