



- Screw locking acc. to DIN EN 61076-2-111
- Degree of protection IP67
- Easy assembly
- Power supply up to 630 V AC/12 A
- Angled connectors adjustable in 4 positions
- Panel mount connector with single wires/screw clamp contacts

## Description

Male cable connector, for power supply

## Drawing

## Contacts

## Cable outlet

## Ordering-No.

2+PE

8–10 mm

99 0685 19 03

3+PE

99 0689 19 04

**NEW**

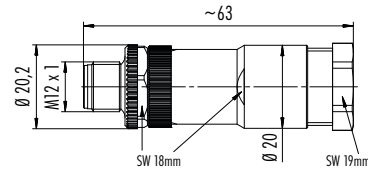

c us

Male angled connector, for power supply

3+PE

8–10 mm

99 0689 58 04

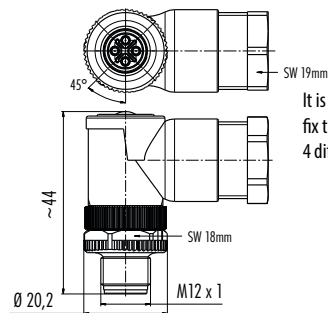

c us

Female cable connector, for power supply

2+PE

8–10 mm

99 0686 19 03

3+PE

99 0690 19 04

**NEW**

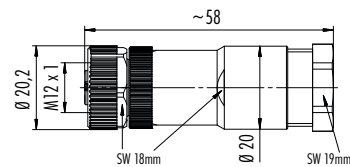

c us

Female angled connector, for power supply

3+PE

8–10 mm

99 0690 58 04

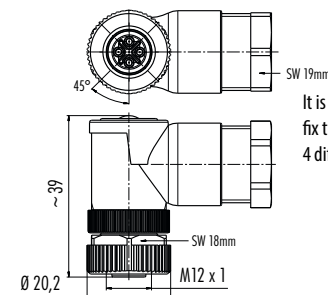



c us

## Specifications

Contacts	2+PE	3+PE
Wire gauge	max. 2,5 mm <sup>2</sup> (max. AWG 14)	max. 1,5 mm <sup>2</sup> (max. AWG 16)
Mechanical operation	> 100 Mating cycles	
Temperature range	– 40 °C / + 85 °C	
Rated voltage	630 V	
Pollution degree	3	
Rated current (40°C)	16 A	12 A
Contact plating	Au (Gold)	
Material of housing	PA	

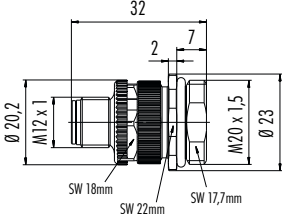
Description	Drawing	Contacts	Fixing thread	Ordering-No.
Male panel mount connector, screw clamp termination		3+PE	M20 x 1,5	99 0693 500 04







Male panel mount connector, with single wires

2+PE x AWG 16  
3+PE x AWG 16

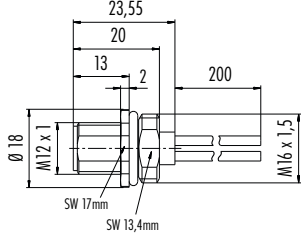
M16 x 1,5

09 0687 700 03  
09 0691 700 04



NEW

Male panel mount connector, front fastened, with single wires

3+PE x AWG 16

M16 x 1,5

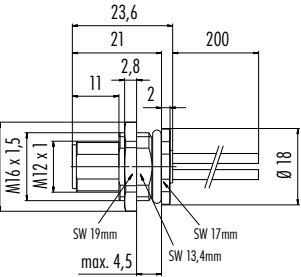
09 0691 121 04







Male panel mount connector, with single wires

3+PE x AWG 16

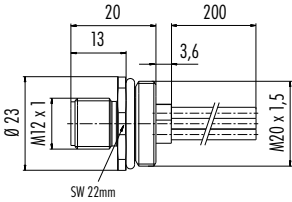
M20 x 1,5

09 0691 642 04







Male panel mount connector, rectangular flange, with single wires

3+PE x AWG 16

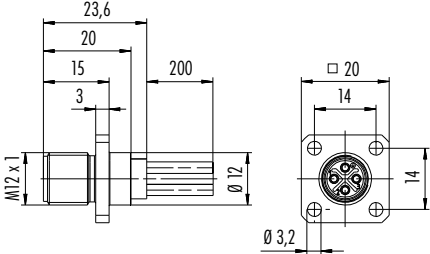
—

09 0691 070 04

NEW

Component part drawing

Cable- and angled connectors

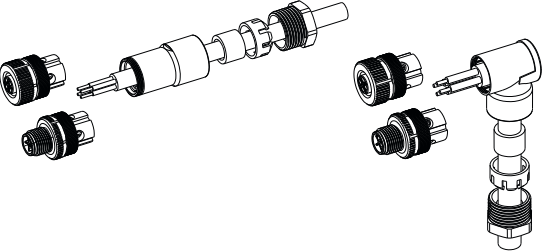

- Female insert/
- Male insert
- Sleeve/
- Angled housing
- Seal
- Pinch ring
- Pressing screw

Rating

Derating curve according to DIN EN 60512 for POWER cable connectors S-Coding 4 contacts

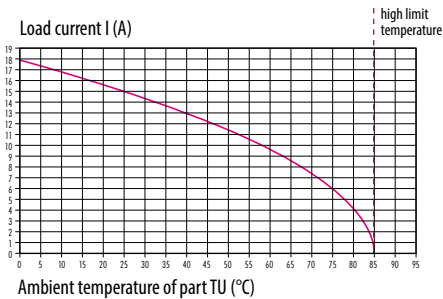

Description	Drawing	Contacts	Fixing thread	Ordering-No.
Female panel mount connector, screw clamp termination		3+PE	M20 x 1,5	99 0694 500 04

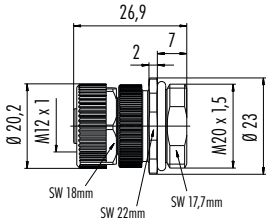

Female panel mount connector, with single wires

2+PE x AWG 16	M16 x 1,5	09 0688 700 03	NEW
3+PE x AWG 16		09 0692 700 04	

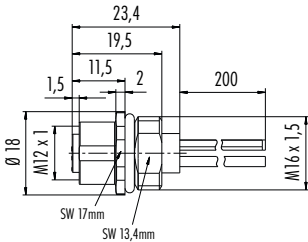

Female panel mount connector, front fastened, with single wires

3+PE x AWG 16	M16 x 1,5	09 0692 121 04
---------------	-----------	----------------

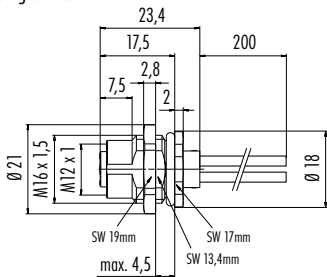

Female panel mount connector, with single wires, M20 x 1,5

3+PE x AWG 16	M20 x 1,5	09 0692 642 04
---------------	-----------	----------------

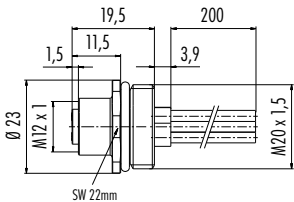

Female panel mount connector, rectangular flange, with single wires

3+PE x AWG 16	AWG 16	09 0692 070 04
---------------	--------	----------------

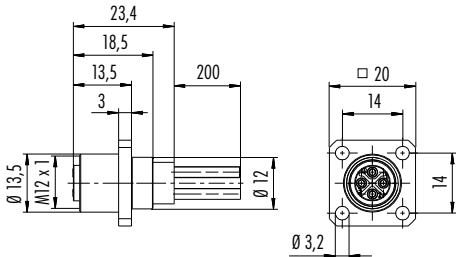

Component part drawing

Panel mount connector, screw clamp termination, not shieldable

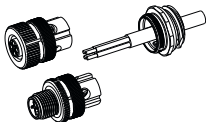

Contact arrangements male insert (mating side)

2+PE contacts



3+PE contacts



Contact arrangements female insert (mating side)



Colour of wire			
2+PE contacts		3+PE contacts	
1	black 1	1	black 1
2	not connected	2	black 2
3	black 3	3	black 3
⊕	yellow/green	⊕	yellow/green

Panel cut out

Panel mount connector

With flats as anti-rotation device

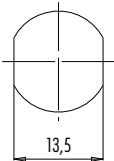

With bore hole

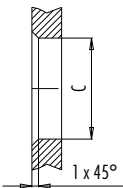

With thread to screw in

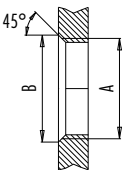

	A	B	C
PG 9	PG 9	16,2	15,3
M16x1,5	M16x1,5	17,0	16,1

Tightening moment	
Metal housing	6,25 Nm
Plastic housing	3,75 Nm

alternativ

Panel mount connector, front fastened

With flats as anti-rotation device

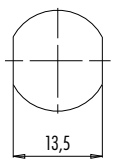

With bore hole

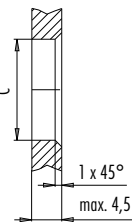

	C
PG 9	15,3
M16x1,5	16,1

Tightening moment	
Metal housing	6,25 Nm
Plastic housing	3,75 Nm

Panel mount connector, positioning possible

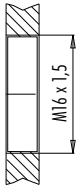

Tightening moment	
Metal housing	6,25 Nm
Plastic housing	3,75 Nm

Panel mount connector, screw clamp termination

With bore hole

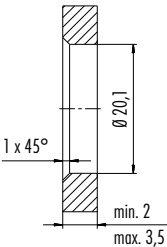

With thread to screw in

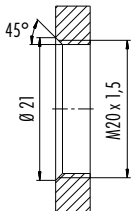

Tightening moment	
M20 x 1,5	2 Nm

Panel mount connector, square flange

