

Description

Drawing

Contacts Cable outlet

Ordering-No.

Male cable connector

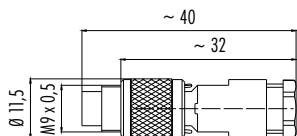

2		99 0401 00 02
3		99 0405 00 03
4	3,5–5 mm	99 0409 00 04
5		99 0413 00 05
7		99 0421 00 07
8		99 0425 00 08

Male cable connector, shieldable

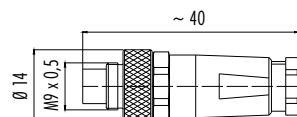

2		99 0401 10 02
3		99 0405 10 03
4	3,5–5 mm	99 0409 10 04
5		99 0413 10 05
7		99 0421 10 07
8		99 0425 10 08

Male cable connector, shieldable, iris type spring

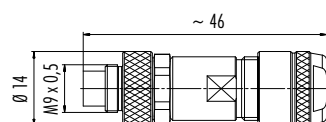

2		99 0401 115 02
3		99 0405 115 03
4	4–5,5 mm	99 0409 115 04
5		99 0413 115 05
7		99 0421 115 07
8		99 0425 115 08

Female cable connector

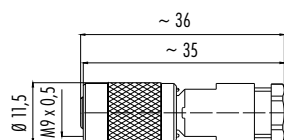

2		99 0402 00 02
3		99 0406 00 03
4	3,5–5 mm	99 0410 00 04
5		99 0414 00 05
7		99 0422 00 07
8		99 0426 00 08

Female cable connector, shieldable

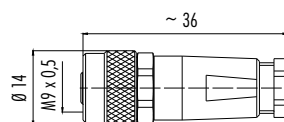

2		99 0402 10 02
3		99 0406 10 03
4	3,5–5 mm	99 0410 10 04
5		99 0414 10 05
7		99 0422 10 07
8		99 0426 10 08

Female cable connector, shieldable, iris type spring

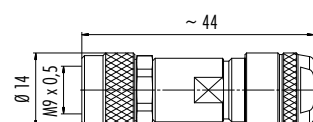

2		99 0402 115 02
3		99 0406 115 03
4	4–5,5 mm	99 0410 115 04
5		99 0414 115 05
7		99 0422 115 07
8		99 0426 115 08

Description

Male cable connector, moulded

Drawing

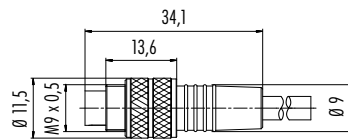

Contacts

Cable length, PUR

Ordering-No.

3 x 0,25	2 m	79 1451 212 03
	5 m	79 1451 215 03
5 x 0,25	2 m	79 1455 212 05
	5 m	79 1455 215 05
8 x 0,25	2 m	79 1461 212 08
	5 m	79 1461 215 08

Male cable connector, moulded, shielded

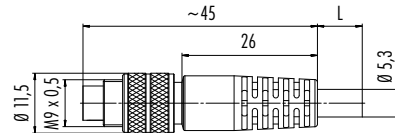

2 x 0,25	2 m	79 1401 12 02
	5 m	79 1401 15 02
3 x 0,25	2 m	79 1405 12 03
	5 m	79 1405 15 03
4 x 0,25	2 m	79 1409 12 04
	5 m	79 1409 15 04
5 x 0,25	2 m	79 1413 12 05
	5 m	79 1413 15 05
7 x 0,14	2 m	79 1421 12 07
	5 m	79 1421 15 07
8 x 0,14	2 m	79 1425 12 08
	5 m	79 1425 15 08

Male angled connector, moulded

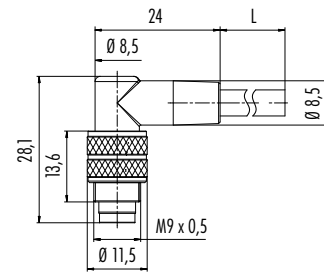

3 x 0,25	2 m	79 1451 272 03
	5 m	79 1451 275 03
5 x 0,25	2 m	79 1455 272 05
	5 m	79 1455 275 05
8 x 0,25	2 m	79 1461 272 08
	5 m	79 1461 275 08

Male angled connector, moulded, shielded

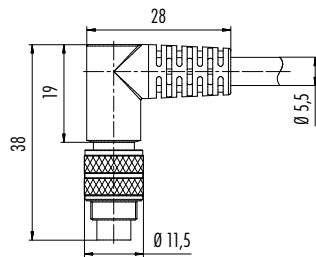

2 x 0,25	2 m	79 1401 72 02
	5 m	79 1401 75 02
3 x 0,25	2 m	79 1405 72 03
	5 m	79 1405 75 03
4 x 0,25	2 m	79 1409 72 04
	5 m	79 1409 75 04
5 x 0,25	2 m	79 1413 72 05
	5 m	79 1413 75 05
7 x 0,14	2 m	79 1421 72 07
	5 m	79 1421 75 07
8 x 0,14	2 m	79 1425 72 08
	5 m	79 1425 75 08

Contact arrangements male insert (mating side)

2 contacts



3 contacts



4 contacts



5 contacts



7 contacts



8 contacts



Contact arrangements female insert (mating side)



Panel cut out

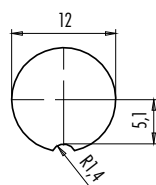

Colour of wire, moulded cable connectors

- | | |
|----------|--------|
| 1 white | 5 grey |
| 2 brown | 6 pink |
| 3 green | 7 blue |
| 4 yellow | 8 red |

Description

Drawing

Contacts

Cable length, PUR

Ordering-No.

Female cable connector, moulded

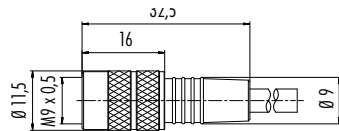

3 x 0,25	2 m	79 1452 212 03
	5 m	79 1452 215 03
5 x 0,25	2 m	79 1456 212 05
	5 m	79 1456 215 05
8 x 0,25	2 m	79 1462 212 08
	5 m	79 1462 215 08

Female cable connector, moulded, shielded

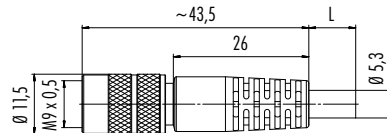

2 x 0,25	2 m	79 1402 12 02
	5 m	79 1402 15 02
3 x 0,25	2 m	79 1406 12 03
	5 m	79 1406 15 03
4 x 0,25	2 m	79 1410 12 04
	5 m	79 1410 15 04
5 x 0,25	2 m	79 1414 12 05
	5 m	79 1414 15 05
7 x 0,14	2 m	79 1422 12 07
	5 m	79 1422 15 07
8 x 0,14	2 m	79 1426 12 08
	5 m	79 1426 15 08

Female angled connector, moulded

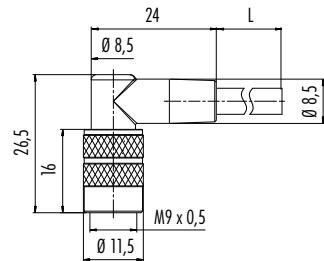

3 x 0,25	2 m	79 1452 272 03
	5 m	79 1452 275 03
5 x 0,25	2 m	79 1456 272 05
	5 m	79 1456 275 05
8 x 0,25	2 m	79 1462 272 08
	5 m	79 1462 275 08

Female angled connector, moulded, shielded

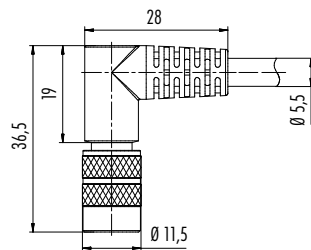

2 x 0,25	2 m	79 1402 72 02
	5 m	79 1402 75 02
3 x 0,25	2 m	79 1406 72 03
	5 m	79 1406 75 03
4 x 0,25	2 m	79 1410 72 04
	5 m	79 1410 75 04
5 x 0,25	2 m	79 1414 72 05
	5 m	79 1414 75 05
7 x 0,14	2 m	79 1422 72 07
	5 m	79 1422 75 07
8 x 0,14	2 m	79 1426 72 08
	5 m	79 1426 75 08

Description	Drawing	Contacts	Ordering-No.
Male panel mount connector		2 3 4 5 7 8	09 0403 00 02 09 0407 00 03 09 0411 00 04 09 0415 00 05 09 0423 00 07 09 0427 00 08

Male panel mount connector, front fastened		2 3 4 5 7 8	09 0403 80 02 09 0407 80 03 09 0411 80 04 09 0415 80 05 09 0423 80 07 09 0427 80 08
--	--	----------------------------	--

Male panel mount connector, dip-solder termination, front fastened		2 3 4 5 7 8	09 0403 90 02 09 0407 90 03 09 0411 90 04 09 0415 90 05 09 0423 90 07 09 0427 90 08
--	--	----------------------------	--

Male panel mount connector, dip-solder termination, front fastened, shielding sheet 6 mm		2 3 4 5 7 8	09 0403 30 02 09 0407 30 03 09 0411 30 04 09 0415 30 05 09 0423 30 07 09 0427 30 08
--	--	----------------------------	--

Male panel mount connector, dip-solder termination, front fastened, shielding sheet 10 mm		2 3 4 5 7 8	09 0403 35 02 09 0407 35 03 09 0411 35 04 09 0415 35 05 09 0423 35 07 09 0427 35 08
---	--	----------------------------	--

		Male panel mount connector	Female panel mount connector
Male panel mount connector/Female panel mount connector with flexible PCB		2 3 4 5 7 8	– – – – 09 0423 65 07 09 0428 65 08

Description

Drawing

Contacts

Ordering-No.

Female panel mount connector

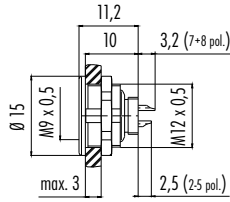

2	09 0404 00 02
3	09 0408 00 03
4	09 0412 00 04
5	09 0416 00 05
7	09 0424 00 07
8	09 0428 00 08

Female panel mount connector, front fastened

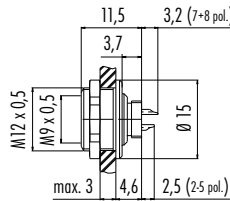

2	09 0404 80 02
3	09 0408 80 03
4	09 0412 80 04
5	09 0416 80 05
7	09 0424 80 07
8	09 0428 80 08

Female panel mount connector, dip-solder termination, front fastened

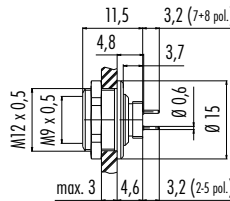

2	09 0404 90 02
3	09 0408 90 03
4	09 0412 90 04
5	09 0416 90 05
7	09 0424 90 07
8	09 0428 90 08

Female panel mount connector, dip-solder termination, front fastened, shielding sheet 6 mm

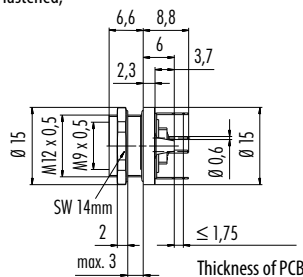

2	09 0404 30 02
3	09 0408 30 03
4	09 0412 30 04
5	09 0416 30 05
7	09 0424 30 07
8	09 0428 30 08

Female panel mount connector, dip-solder termination, front fastened, shielding sheet 10 mm

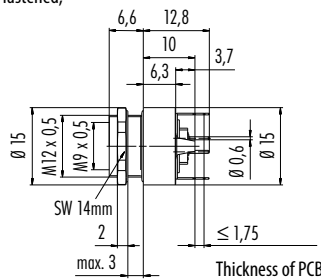

2	09 0404 35 02
3	09 0408 35 03
4	09 0412 35 04
5	09 0416 35 05
7	09 0424 35 07
8	09 0428 35 08

Female angled panel mount connector, Dip-Solder termination, front fastened, shielding sheet

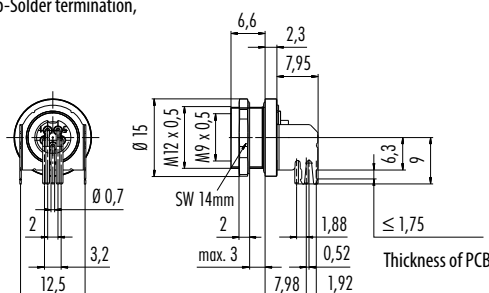

2	09 0404 55 02
3	-
4	-
5	09 0416 55 05
7	-
8	-

Component part drawing

Cable connectors

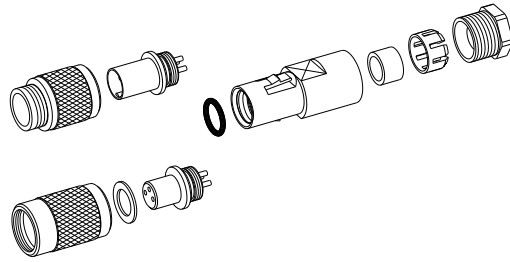

- Connection ring male connector
- Connection ring female connector
- Flat seal
- Female insert
- Male insert
- O-ring 6x1
- Snap bushing
- Seal
- Pinch ring
- Pressing screw

Cable connectors, shieldable

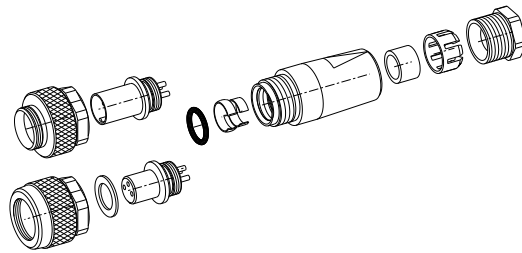

- Connection ring male connector
- Connection ring female connector
- Flat seal
- Female insert
- Male insert
- O-ring 6x1
- Snap bushing
- Seal
- Pinch ring
- Pressing screw

Cable connectors, shieldable, with iris type spring

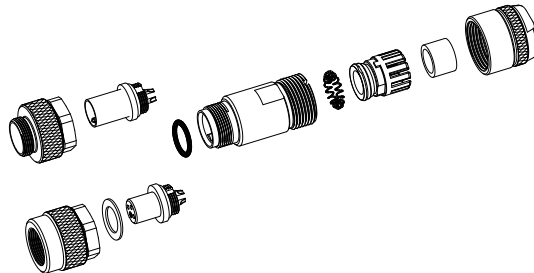

- Connection ring male connector
- Connection ring female connector
- Female insert
- Male insert
- Sleeve
- Iris type spring
- Pinch ring
- Seal
- Pressing screw

Angled connectors

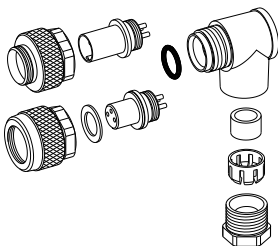

- Connection ring male connector
- Connection ring female connector
- Dichtung
- Female insert solder
- Male insert solder
- O-ring 6x1
- Angled housing
- Seal
- Pinch ring
- Pressing screw
- Cable outlet adjustable in 2 positions (0°/180°)

Angled connectors, shielded

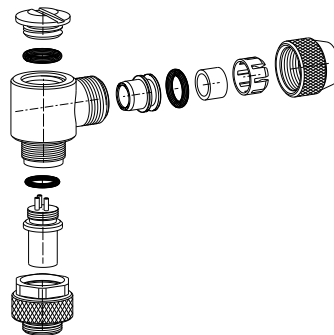

- Connection ring male connector
- Male insert
- O-ring 6x1,5
- Angled housing
- O-ring 6x1,5
- Screw plug
- Shielding ring
- O-ring 6x1,5
- Seal
- Pinch ring
- Pressing screw
- Cable outlet adjustable in 2 positions (0°/180°)

Description

Adapter lead-through for control cabinet



Drawing

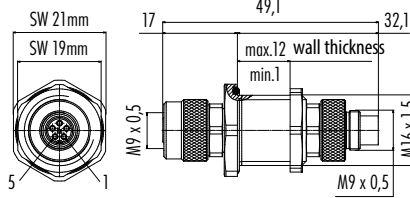

Contacts

5

Ordering-No.

09 9618 100 05

Protection cap for male cable connector

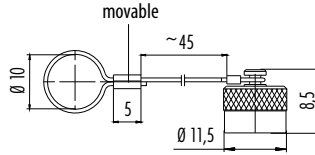

Ordering-No.

08 0349 000 001

Protection cap for female cable connector

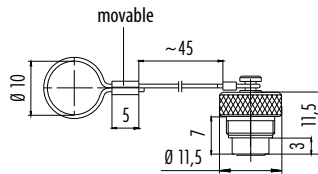

08 0350 000 001

Protection cap for male panel mount connector

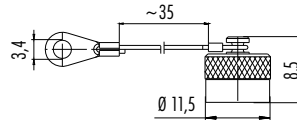

08 0351 000 001

Protection cap for female panel mount connector

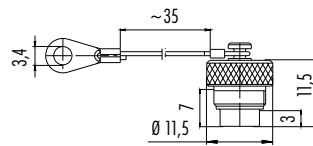

08 0352 000 001

Square flange with seal

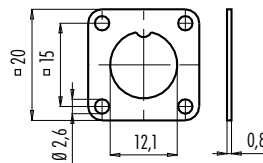

08 1124 000 001

Solder eye ring

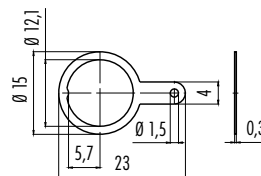

04 0208 002

Knurled hexagonal nut, 2 mm, 4 mm

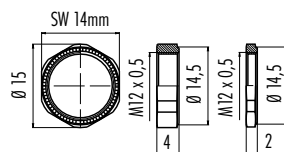

01 0013 001 2 mm thickness

01 5023 001 4 mm thickness

Mounting spanner

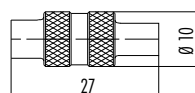

01 5059 001