

FEATURES

- mounts up to 48 1.0/2.3(f) bulkhead connectors
- zinc sealed, powder coated steel
- RoHS compliant
- ETSI 21", 2SU

MATERIALS

Panel: Steel zinc coated, Powder Coated Black

CONNECTOR HOLE SIZE

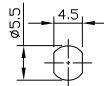

ENVIRONMENTAL

Working Temperature: -30°C to 75°C
 RoHS Compliance: To EU Directive 2011/65/EU

RELATED PRODUCTS

1.0/2.3(f) Connectors: J30XYYY-ZZZ (actual part number depends on cable type)
 1.0/2.3(f) Thru Adaptor: A30BB35
 1.0/2.3(f) Balun: B04044010