

FEATURES

- mounts up to 48 1.6/5.6(f) bulkhead connectors
- zinc sealed, powder coated steel
- RoHS compliant
- ETSI 21", 2SU

MATERIALS

Panel: Steel zinc coated, Powder Coated Black

CONNECTOR HOLE SIZE

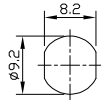

ENVIRONMENTAL

Working Temperature: -30°C to 75°C
 RoHS Compliance: To EU Directive 2011/65/EU

RELATED PRODUCTS

- 1.6/5.6(f) Connectors: J10YYYY-ZZZ (actual part number depends on cable type)
- 1.6/5.6 (f) Thru Adaptor: A10BB10
- 1.6/5.6 (f) Balun: B13003010
- 1.6/5.6 U-Link: A15UB15
- 1.6/5.6 F-Link: A001717/15/2/N
- 1.6/5.6 H-Link: A15HB15-ZZ (ZZ = monitor port attenuation in dB)